

# FOR LEASE

30942 Industrial Road,  
Livonia



Office/Light Industrial

Local Ownership and Management

## Features

- 4,000 SF
- 500 Office SF, Will Build to Suit
- 12' X 12' Overhead Door
- 10' X 10' Truckwell
- 16' – 18' Clearance
- Newly Landscaped
- Ample Parking
- May be combined with unit 30942A for a total of 7,170 sf

## Location

- Just South of I-96 Between Merriman and Middlebelt
- Conveniently Located to I-96, I-275 and Telegraph

## Leasing

- Fast Occupancy
- Flexible Lease Terms
- Competitive Rates - \$6.50 gross / \$2,167/mo.

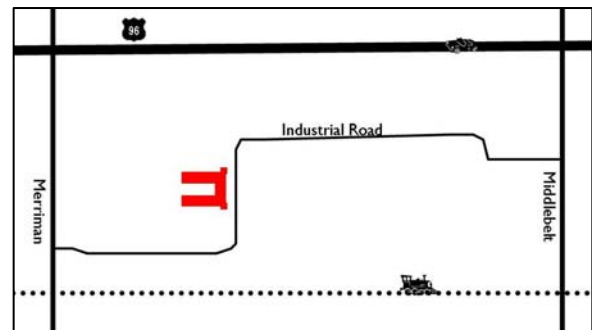

## Please contact:

Tyson Butts  
Corporate Leasing Manager  
248.331.0215  
tbutts@gvadetroit.com



PO Box 4013  
Southfield, MI 48037

[www.zicorproperty.com](http://www.zicorproperty.com)

Information contained herein is believed to be accurate but is not warranted as to accuracy and may change or be updated without notice. Seller or landlord makes no representation as to the environmental condition of the property and recommends Purchaser's or Tenant's personal investigation.

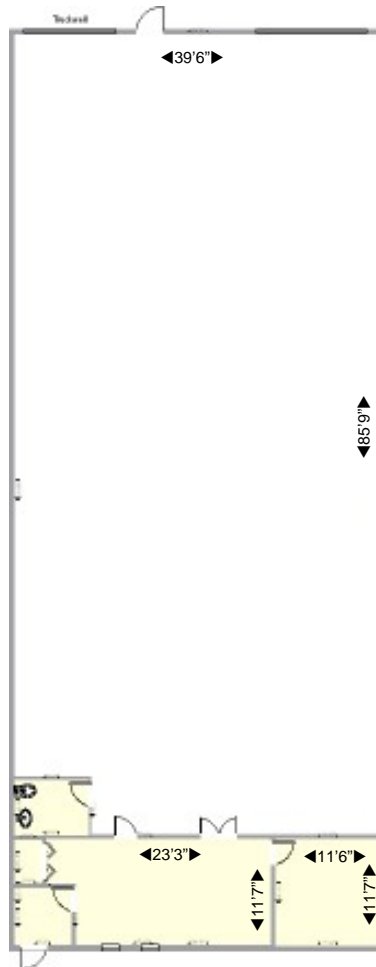
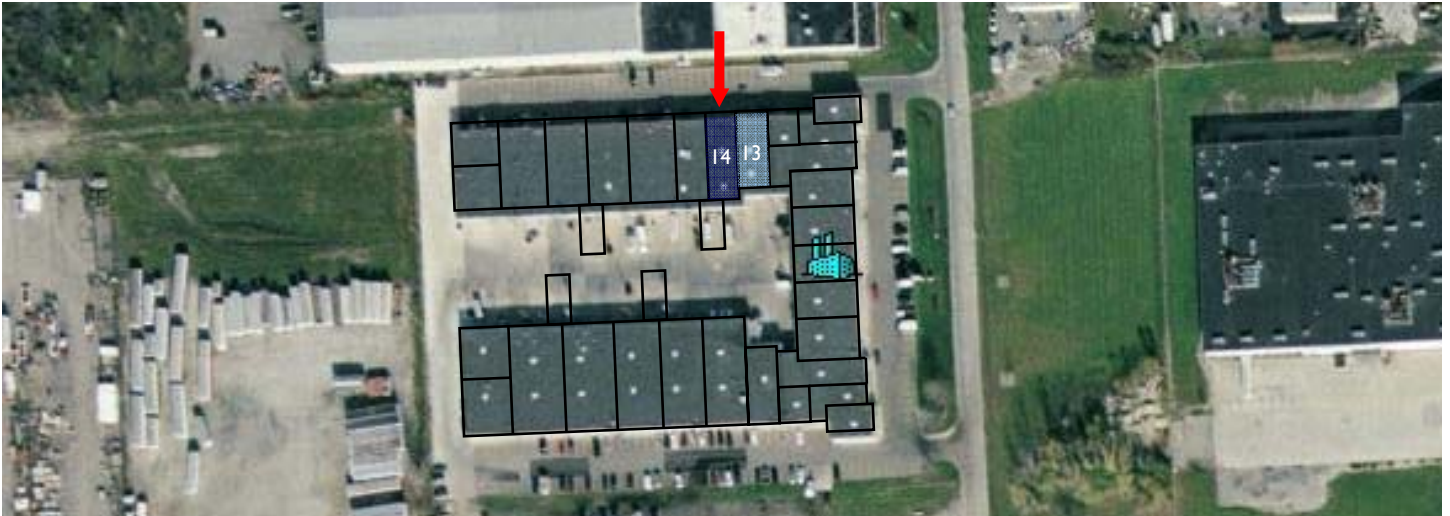

Dimensions are approximate and should be verified by Tenant.

## Unit 14

Tyson Butts  
248.331.0215  
tbutts@gvadetroit.com

PO Box 4013  
Southfield, MI 48037  
www.zicorproperty.com